



DESCRIPTION

Reduce wattage up to 80%. A single model T MTB600 using 600W can replace four traditional 1000W metal halide fixtures that use more than 4360W. MTB light engines are designed to deliver exceptional, high-lumen output with precise, proprietary optics for your specific application. MTB is a low-profile fixture that features a sleek, contemporary compact form factor with minimal EPA wind load factor. Constructed of aluminum with a durable, automotive quality exterior finish. Bronze, Black, Gray and White are standard. Custom powder coat colors and finishes are available. Logo options available to further enhance your branding. Patent-pending Pinnacle[®] mounting system for fast, easy secure mounting on poles also incorporates unique sacrificial anode to protect pole from rust. Patent-pending Forced Vector Cooling[®] provides thermal protection for components for significantly longer life with superior lumen maintenance and light output.



MTB
Shown with optional sensor.

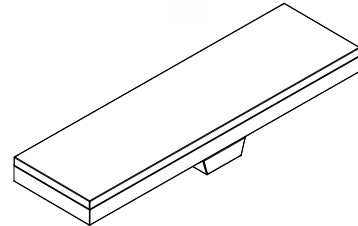

SPECIFICATIONS

Lumens:	50,175	52,339	54,504	56,668	58,832	60,996	63,160	65,324	66,930
Wattage:	400	425	450	475	500	525	550	575	600
Weight:	81 lbs.								
Dimensions:	L 64.126" x W 18.125" x H 8.513"								
EPA:	3.25 ft ²								
Listed/Rated:	DLC QPL, ETL								
DLC Model #	MTB600-UNFD-HM[ALL COLORS]-[ALL CONTROLS]-[ALL CUSTOMIZATIONS]-[ALL MOUNTING] MTB600-UNCD-HM[ALL COLORS]-[ALL CONTROLS]-[ALL CUSTOMIZATIONS]-[ALL MOUNTING] MTB600-48CD-HM[ALL COLORS]-[ALL CONTROLS]-[ALL CUSTOMIZATIONS]-[ALL MOUNTING] MTB600-48FD-HM[ALL COLORS]-[ALL CONTROLS]-[ALL CUSTOMIZATIONS]-[ALL MOUNTING]								
Color Temp:	5000K								
CRI:	>83								
Line Voltage:	Universal 120-277V. 480V option.								
Power Supply:	Hardwire standard								
Surge Protection:	Internal integrated 6kV transient voltage protection. External 10kA (L1-L2) or 20kA (L1-G & L2-G) surge protection.								
Ambient Operating Temperature:	-30° to 40° C / -22° to 104° F (@ 600W)								
Environment:	Wet rated								
Lens:	Glass, anti-reflective glass, Type III (FD) forward-throw or Type V (CD) bi-directional.								
Mount:	Pinnacle [®] universal mounting system. V-Base, Tenon, Bull Horn, Wall Mount options.								
Warranty:	10-year Standard Limited								
Manufacturer:	Genesis Energy Technology								



Designed & Built in USA



model T[®] MTB

ORDERING INFORMATION

EXAMPLE: **MTB600-UNFD-HMBZ-NNN-NP** Lead times and costs may vary depending on options selected. Consult your sales representative for more information. Standard configuration highlighted in Gray.

MTB		HM						
Model	Wattage	Voltage	Optics	Reflector	Fixture Color	Motion Sensor	Customization	Mounting
MTB: model T	600: 600W	UN: 120-277V	FD: Forward Throw	HM: Hammertone	BL: Black	NNN: No Sensor	N: None	P: Pinnacle V-Base
	575: 575W	48: 480V*	CD: Bi-Directional		WH: White	MNN: Wattstopper <i>FSP-211 (120-277V)</i>	L: Logo	T: Tenon V-Base
	550: 550W				GR: Gray	<i>*Motion sensor not available with 480V</i>	A: Anti-reflective glass lens	
	525: 525W				BZ: Bronze			
	500: 500W							
	475: 475W							
	450: 450W							
	425: 425W							
	400: 400W							

Specifications subject to change without notice.

Standard colors

Durable, automotive quality finish in:

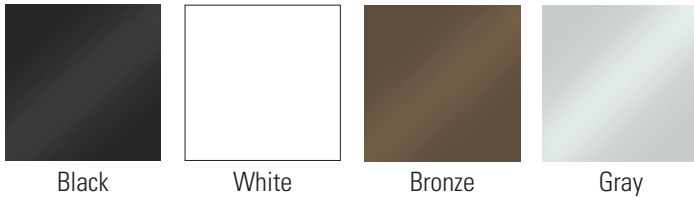

Custom logo and custom model T colors

Place your company logo on the model T to further enhance your brand. Submit logo in .AI or .EPS format for best results.

Custom colors are available for the model T. Contact your sales representative for more details.

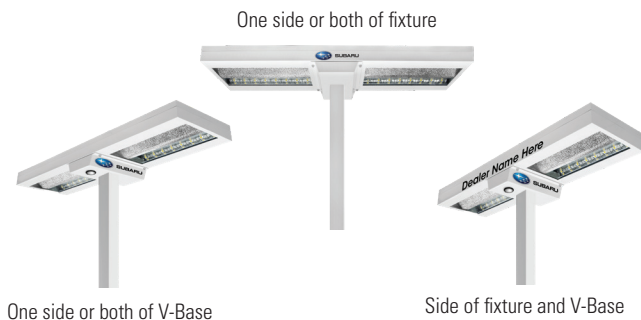

Mounting Options

V-base Pinnacle Mounting: option accommodates addition of accessories and controls including Doppler or microwave on any square, round or tapered 4" - 6" pole.

V-base with Tenon: option accommodates addition of accessories and controls including Doppler or microwave on existing 2.375" tenon.

Bullhorn (BH01-xx): fits two (2) standard model T fixtures on any square, round or tapered 4" - 6" pole.

Tenon Bullhorn (BH02-xx): fits two (2) standard model T fixtures on any square or round pole with existing 2.375" tenon.

Tenon Wall Mount Bracket (WM01-xx): fits one (1) standard model T fixture with 2.375" tenon mount onto building wall of adequate structural strength.

Pinnacle[®] Mounting System

Fast, easy, secure and unobtrusive mounting of the fixture on almost any pole without adapters. Also incorporates unique sacrificial anode to help protect pole from rust.



energybank.

www.energybankinc.com

© 2018 EB SPEC modelT MTB600 20180430